

CLOSE COUPLED CENTRIFUGAL PUMP



PAZ SERIES

PUMP KEY

PAZ 32 - 20 / 5.5 - 2

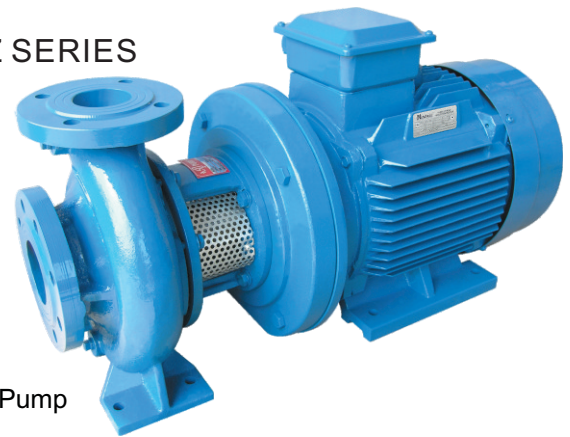
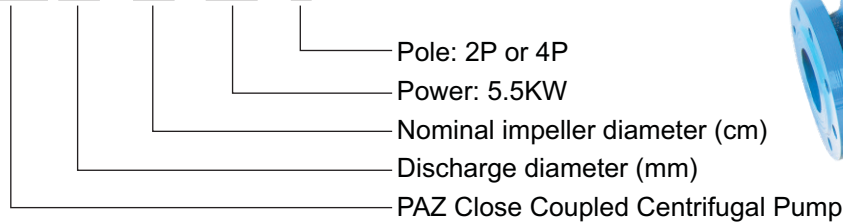

TECHNICAL INFORMATION

- * Design : DIN 24255 standard
- * Operating pressure : Max. 16bar standard
- * Hydrostatic test pressure : 15bar standard; 24bar optional
- * Operating temperature : -20°C to +100°C standard
- * Operating speed : 50 Hz, 1450rpm and 2900 rpm; 60 Hz, 1750rpm and 3500 rpm
- * Discharge flange: 32mm~150mm
- * Flange standard: BS4504PN16 (ANSI 150RF optional)
- * Flow rate: up to 550m³/h
- * Total head: up to 150m

FEATURE OF CONSTRUCTION

- * The PAZ Series Close Coupled Centrifugal Pumps meet the DIN 24255 standard specification for horizontal installation centrifugal pumps. The PAZ Series offers many features and benefits that improve performance, increase reliability and reduce maintenance time and cost.
- * Heavy-duty cast iron casing with integral cast feet suitable for maximum 16 bar working pressure. Centerline discharge assures that the casing is self-venting.
- * Flanges to BS4504PN16 as standard.
- * Back pull out design for fast and easy maintenance.
- * Maximum interchangeability for low spare parts inventory with 3 shaft sizes for 127 sizes of pumps.
- * Replaceable wear rings to assure optimum efficiency and performance at all times.
- * Shaft seal is available as mechanical seal.
- * Double shrouded, hydraulically balanced impellers with back vanes to minimize gland pressure in cast iron or bronze as standard.
- * Heavy-duty shaft in stainless steel for longer life and to assure product purity.
- * Stainless steel shaft sleeve for product purity, longer mechanical seal life and to prevent damage to the shaft from mechanical seal.
- * Operating temperature from -20°C to +100°C as standard.
- * The pump is supplied complete with Montroli® MC Series 3-Phase Cast Iron Electric Motor (Flange or face mounted, TEFC, Ip55, Class F, IEC standard). Single phase motor is also available.

CLOSE COUPLED CENTRIFUGAL PUMP



SELECTION CHART



1450r.p.m. / 50Hz

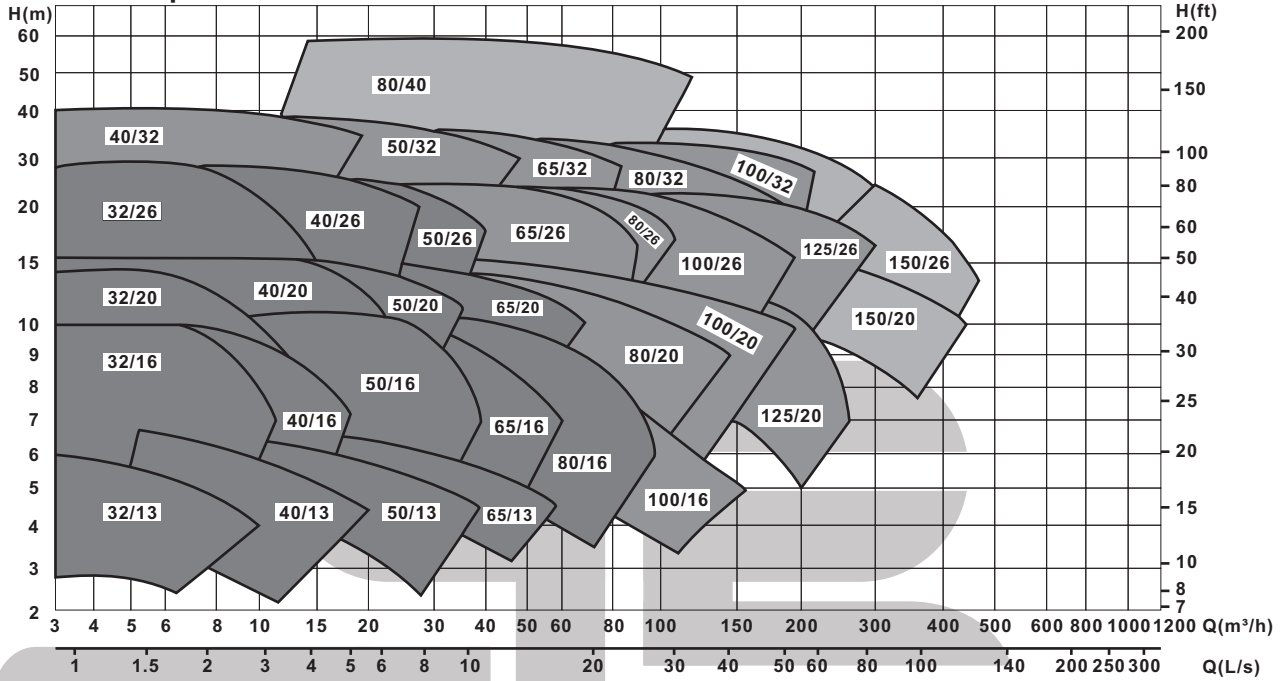

2900r.p.m. / 50Hz

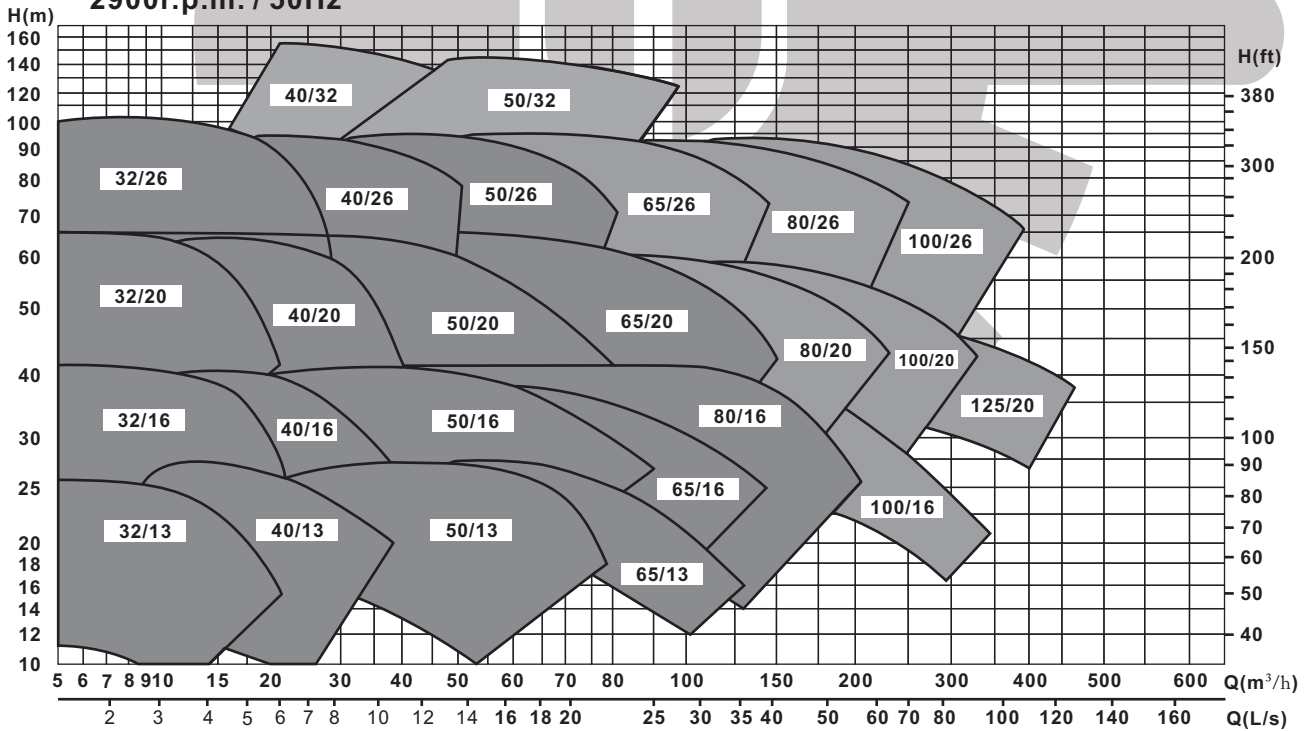

CLOSE COUPLED CENTRIFUGAL PUMP



SELECTION CHART



1750r.p.m. / 60Hz

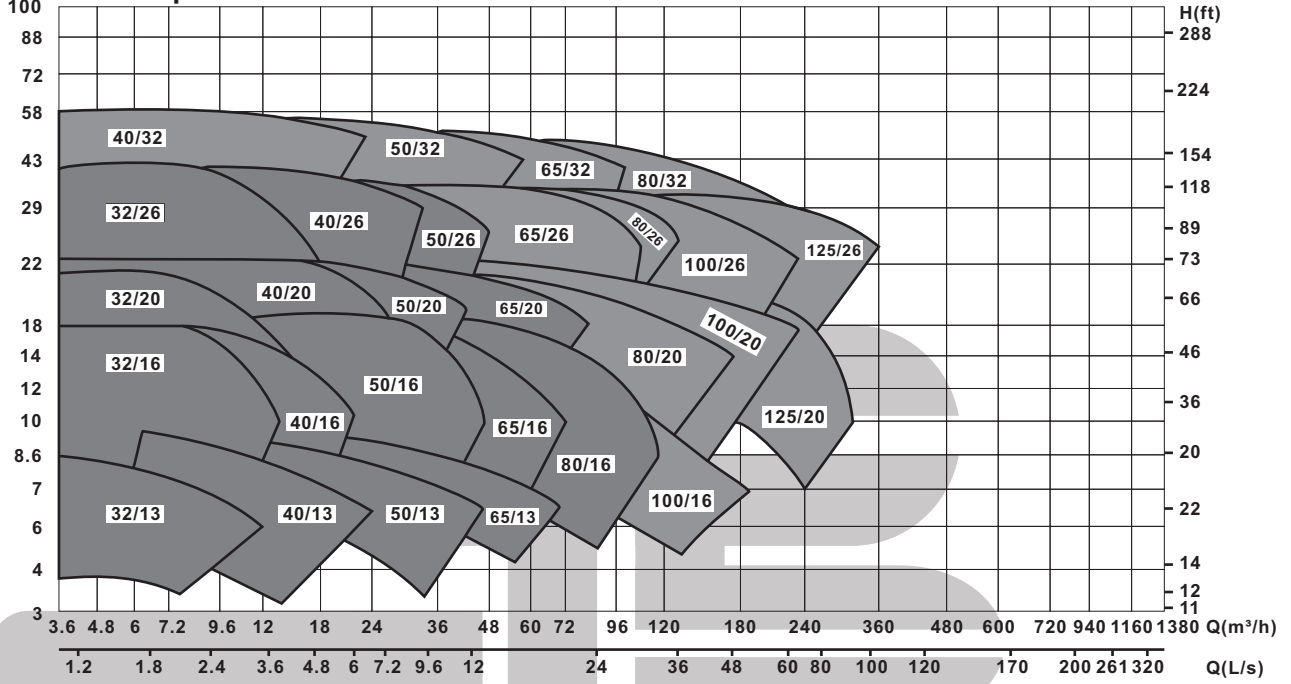

3500r.p.m. / 60Hz

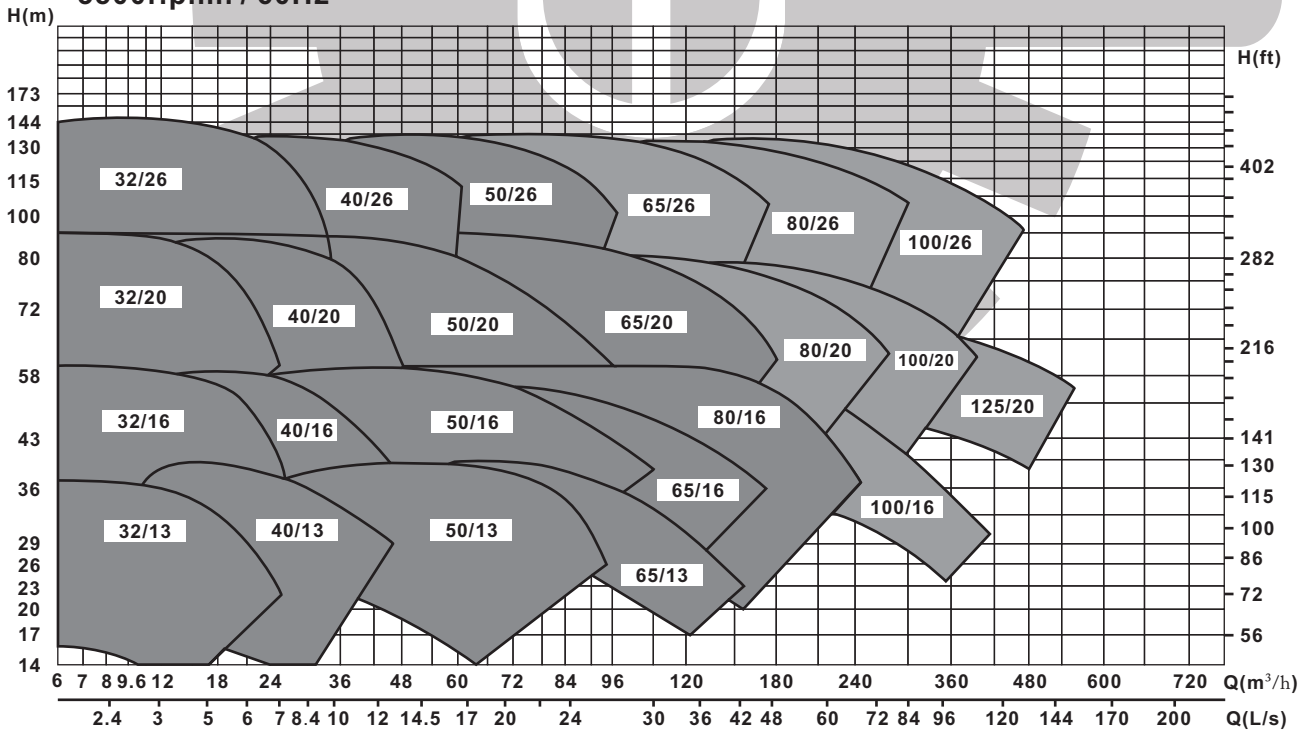

CLOSE COUPLED CENTRIFUGAL PUMP



CROSS SECTION VIEW AND MATERIAL CHART

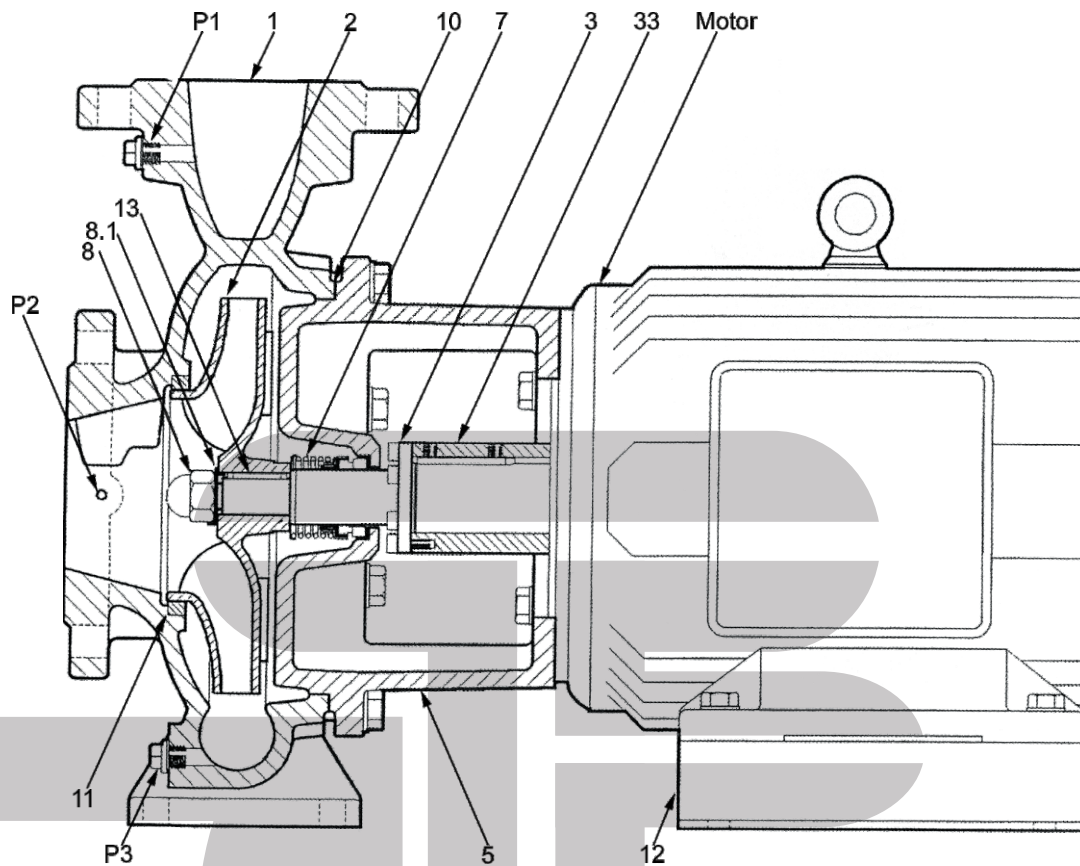

| No. | Pump Parts | Material | |
|-----|--------------------|------------------|------------------|
| | | Cast Iron Fitted | Bronze Fitted |
| 1 | Casing | Cast Iron | Cast Iron |
| 2 | Impeller | Cast Iron | LG4 Bronze |
| 3 | Stub Shaft | Stainless Steel | Stainless Steel |
| 5 | Adaptor | Cast Iron | Cast Iron |
| 7 | Mechanical Seal | Carbon / Ceramic | Carbon / Ceramic |
| 8 | Impeller Nut | Steel | Bronze |
| 8.1 | Impeller Washer | Steel | Steel |
| 10 | Casing O-ring | Rubber | Rubber |
| 11 | Casing Wear Ring | Cast Iron | Cast Iron |
| 12 | Support Foot | Mild Steel | Mild Steel |
| 13 | Impeller Key | Key Steel | Key Steel |
| 33 | Motor Sleeve | Steel | Steel |
| P1 | Vent / Gauge Plug | Steel | Steel |
| P2 | Suction Gauge Plug | Steel | Steel |
| P3 | Drain Plug | Steel | Steel |