

END-SUCTION CENTRIFUGAL PUMP

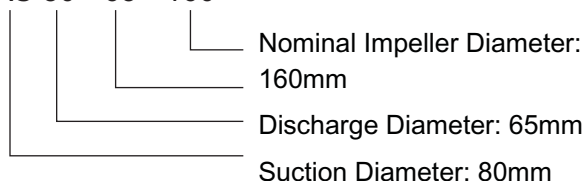

PUMP KEY

AS 80 - 65 - 160



FLANGE STANDARD

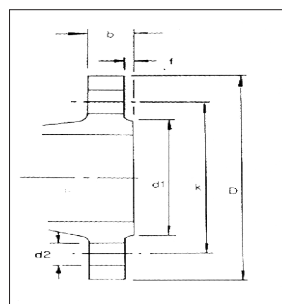

MATERIALS OF CONSTRUCTION	
Pump Parts	Material
Casing	Cast Iron / Stainless Steel
Bearing Housing	Cast Iron
Impeller	Cast Iron / Bronze / Stainless Steel
Wear Ring	Cast Iron / Bronze / Stainless Steel
Shaft	High Tensile Steel / Stainless Steel
Shaft Sleeve	Stainless Steel

Flange Size	Flange		Raised Race		Drilling			Bolting
	D	b	d1	f	No.	d2	k	
32	140	18	78	2	4	18	100	M16
40	150	18	88	3	4	18	110	M16
50	165	20	102	3	4	18	125	M16
65	185	20	122	3	4	18	145	M16
80	200	22	133	3	8	18	160	M16
100	220	24	158	3	8	18	180	M16
125	250	26	184	3	8	18	210	M16
150	280	26	212	3	8	22	240	M20
200	340	30	268	3	12	22	295	M20

Flange dimensions and drilling according to ISO 2084-16Bar.
(BS4504-1969 TABLE 16/11. DIN 2501/Pn 16)

* Holes- Equally spaced straddling pump centreline.

GENERAL DESCRIPTION

ASP AS Series Centrifugal Pump is manufactured in accordance to ISO 2858 Standard. It is a single stage centrifugal pump, suitable for water supply, hot and cold water circulation, irrigation, drainage, handling any non-aggressive liquid, etc.

STANDARD DESIGN

- * Design : ISO 2858
- * Capacity: 6.3m³/hr to 400m³/hr
- * Total Head: 5m to 125m
- * Temperature: Up to 90°C for standard design. Higher temperature version on request.
- * Caing pressure : 16 Bars
- * Rotation: Clockwise view from driver end

CONSTRUCTION

- * Back pull out design.
- * Volute casing is casted integrally with pump foot.
- * Suction diameter is located axially at the pump end. And discharge diameter is located radially and vertically on top.
- * Overhung radial flow impeller and shaft are protected by renewable wear ring and shaft sleeve.

SECTIONAL DRAWING

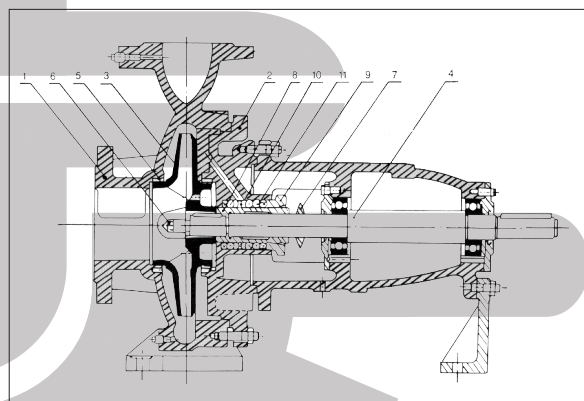

1. Volute Casing
2. Back Casing
3. Impeller
4. Shaft
5. Casing Wear Ring
6. Impeller Nut
7. Water Slinger
8. Shaft Sleeve
9. End Cover
10. Lantern Ring
11. Mechanical Seal / Gland Packing Seal (optional)

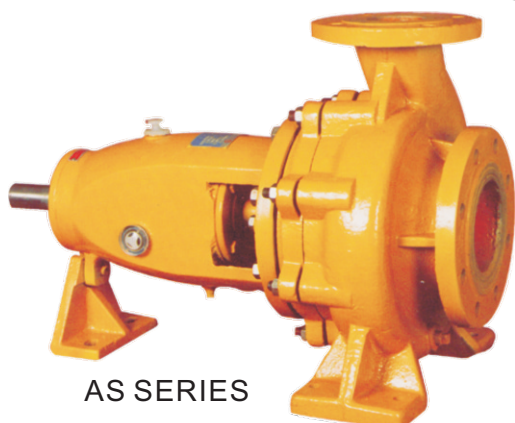

AS SERIES

END-SUCTION CENTRIFUGAL PUMP

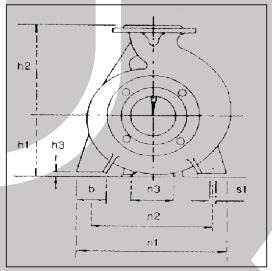
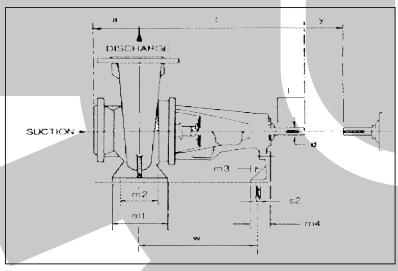
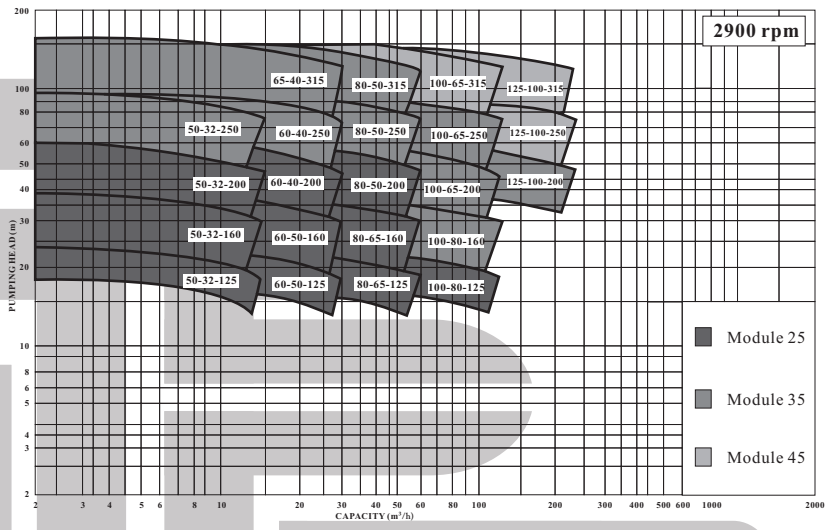
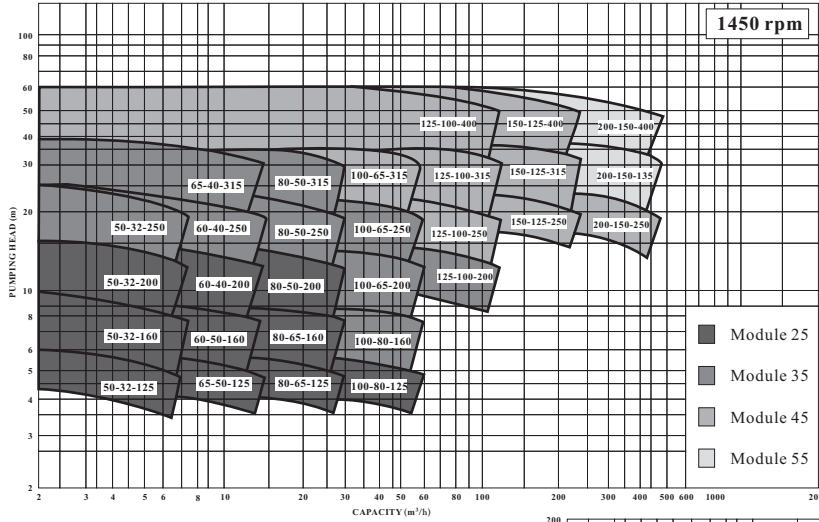

DIMENSION

Model	Overall Dimension (mm)																				
	DN1	DN2	a	f	h1	h2	b	m1	m2	m3	m4	n1	n2	n3	h3	w	s1	s2	d	l	y
AS 50-32-125	50	32	80	385	112	140	50	100	70	19	60	190	140	110	10	285	M 12	M 12	24	50	100
AS 50-32-160	50	32	80	385	132	160	50	100	70	19	60	240	190	110	10	285	M 12	M 12	24	50	100
AS 50-32-200	50	32	80	385	160	180	50	100	70	19	60	240	190	110	10	370	M 12	M 12	24	50	100
AS 50-32-250	50	32	100	500	180	225	65	125	95	25	65	320	250	110	14	285	M 12	M 12	32	80	100
AS 65-50-125	65	50	80	385	112	140	50	100	70	19	60	210	160	110	10	285	M 12	M 12	24	50	100
AS 65-50-160	65	50	80	385	132	160	50	100	70	19	60	240	190	110	10	285	M 12	M 12	24	50	100
AS 65-40-200	65	40	100	385	160	180	50	100	70	19	60	265	212	110	10	285	M 12	M 12	24	50	100
AS 65-40-250	65	40	100	500	180	225	65	125	95	25	65	320	250	110	14	370	M 12	M 12	32	80	100
AS 65-40-315	65	40	125	500	200	250	65	125	95	25	65	345	280	110	14	370	M 12	M 12	32	80	100
AS 80-65-125	80	65	100	385	130	160	50	100	70	19	60	240	190	110	10	285	M 12	M 12	24	50	100
AS 80-65-160	80	65	100	385	160	180	50	100	70	19	60	265	212	110	10	285	M 12	M 12	24	50	100
AS 80-50-200	80	50	100	385	160	200	50	100	70	19	60	265	212	110	10	285	M 12	M 12	24	50	100
AS 80-50-250	80	50	125	500	180	225	65	125	95	25	65	320	250	110	14	370	M 12	M 12	32	80	100
AS 80-50-315	80	50	125	500	225	280	65	125	95	25	65	345	280	110	14	370	M 12	M 12	32	80	100
AS 100-80-125	100	80	100	385	160	180	65	125	95	19	60	280	212	110	10	285	M 12	M 12	24	50	100
AS 100-80-160	100	80	100	500	160	200	65	125	95	24	60	280	212	110	10	370	M 12	M 12	32	80	100
AS 100-65-200	100	65	100	500	180	225	65	125	95	25	65	320	250	110	14	370	M 12	M 12	32	80	140
AS 100-65-250	100	65	125	500	200	250	80	160	120	25	65	360	280	110	14	370	M 16	M 12	32	80	140
AS 100-65-315	100	65	125	530	225	280	80	160	120	28	65	400	315	110	14	370	M 16	M 12	42	110	140
AS 125-100-200	125	100	125	500	200	280	80	160	120	25	65	360	280	110	14	370	M 16	M 12	32	80	140
AS 125-100-250	125	100	140	530	225	280	80	160	120	28	65	400	315	110	14	370	M 16	M 12	42	110	140
AS 125-100-315	125	100	140	530	250	315	80	160	120	28	65	400	315	110	14	370	M 16	M 12	42	110	140
AS 125-100-400	125	100	140	530	280	355	100	200	150	28	65	500	400	110	14	370	M 20	M 12	42	110	140
AS 150-125-250	150	125	140	530	250	355	80	160	120	28	65	400	315	110	14	370	M 16	M 12	42	110	140
AS 150-125-315	150	125	140	530	280	355	100	200	150	28	65	500	400	110	14	370	M 20	M 12	42	110	140
AS 150-125-400	150	125	140	530	315	400	100	200	150	28	65	500	400	110	14	370	M 20	M 12	42	110	140
AS 200-150-250	200	150	160	530	280	375	100	200	150	28	65	500	400	110	14	370	M 20	M 12	42	110	180
AS 200-150-315	200	150	160	670	315	400	100	200	150	38	80	550	450	140	30	500	M 20	M 16	48	110	180
AS 200-150-400	200	150	160	670	315	450	100	200	150	38	80	550	450	140	30	500	M 20	M 16	48	110	180